

Project	
Nomenclature	
Type	Date
Approval	
Notes	

The BLMQ is an LED linear fixture designed for wall mounting. It is well suited for indoor use where high efficiency, task lighting is required. Its narrow design and modern profile make it an ideal fixture for task lighting applications.

### Luminaire Summary

#### Features

- Up/Down light lumen packages ranging from 1L(1000lm) to 5L(5000lm) for each light
- 0-10V dimming standard
- Available in 2700K, 3000K, 3500K, 4000K, 5000K and 6500K

#### Approvals

- Made with UL Listed components
- Dry and Damp Environment Rated

#### Mounting

- Holes provided for V-hangers, S-hook chain-mounting, aircraft cables, surface-mounting, and wall-mounting
- Optional pendant mount

#### Construction

- Manufactured in Ontario, Canada
- Cold-rolled steel parts are precision bent for added strength and rigidity
- Powder-coated finish in low-gloss white

#### Electrical

- Available in 120-277V, 120-347V, 347V and 480V

#### Options

- 90 and 95+ CRI Options Available
- 120-347V(UN3) Available

### Ordering Information

Fill in the fields below with your product selections. If you need help with this section, [contact your local sales professional](#).

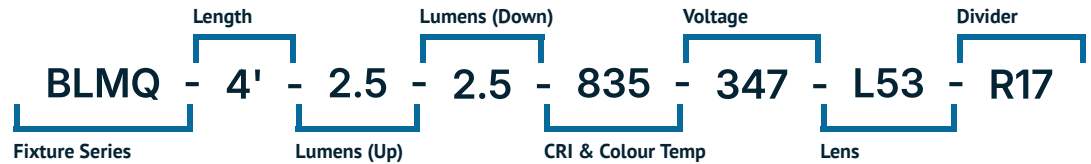

1	2	3	4	5	6	7	8		
BLMQ						L53			
Series	Lumens (Up)		Lumens (Down)		CRI	Colour Temp	Voltage	Lens	Divider
BLMQ	2'	1L	BLANK	None	8 - 80 CRI	27 - 2700K	UNV -	L53	BLANK
	2'	1.5L	2'	1L	9 - 90 CRI	30 - 3000K	120-277V		R17
	2'	2L	2'	1.5L	1 - 95+ CRI	35 - 3500K	UN3 -		
	3'	1L	2'	2L		40 - 4000K	120-347V		
	3'	1.5L	3'	1L		50 - 5000K	347 - 347V		
	3'	2L	3'	1.5L		65 - 6500K	480 - 480V		
	3'	2.5L	3'	2L					
	3'	3L	3'	2.5L					
	4'	2L	3'	3L					
	4'	2.5L	4'	2L					
	4'	3L	4'	2.5L					
	4'	3.5L	4'	3L					
	4'	4L	4'	3.5L					
			4'	4L					

### Options



<b>Down Light</b> BLANK   Not required	<b>Dimming</b> B11   0-10V Dimming Leads B12   Line Voltage Dimming B27   Dim-to-off Driver B**   Other Options Available*	<b>Finish</b> BLANK   Standard Matte White C5   Matte Black CUSTOM*   Custom Colour Choice
<b>Lenses</b> L53   Opal Lens	<b>Emergency Driver</b> B17   UL924 10W Battery Back-up	<b>Packaging</b> BLANK   Individually Boxed on Pallets P0   Bulk Packaging P**   Other Options Available*
<b>Divider</b> BLANK   Not required R17   Up/Down Light Divider	<b>Switches</b> S1   On/Off Pull Chain S2   3-Way Pull Chain	<b>Warranty</b> CL7   10-Year Comprehensive Warranty Upgrade

### Documentation and Resources

All files and resources are available on our website for download. Files and resources are also embedded as links in this document, listed below. Additional files may be available upon request. Please contact your local sales agent [here](#) or contact [sales@bjtake.com](mailto:sales@bjtake.com) for more information.

### Certifications and Listings

Certifications that apply to this fixture and its possible configurations are listed here. More information available upon request.

Icon	Description
	ETL Listed
	90 and 95+ CRI Options Available
	120-347V(UN3) Available

### Usage Applications

This fixture can be used in a variety of applications, and is ideal for the following:

Usage Application
Displays
Hospitals
Task Lighting
Retail Stores

### Warranty Statement

BJ Take products are tested and/or inspected prior to being packaged for shipment and are guaranteed from the day the product is shipped for a period of ten-year LED chip warranty and a five-year comprehensive component warranty. This can be upgraded to a ten-year comprehensive warranty on request.

### BLMQ, 2 Foot, Side Dims

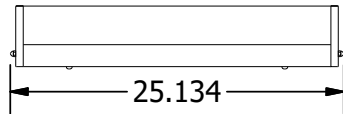

### End View

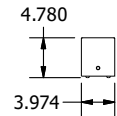

### BLMQ, 3 Foot, Side Dims

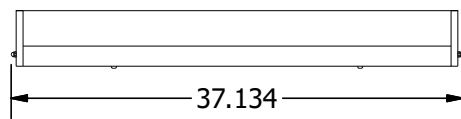

### End View

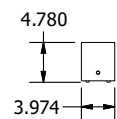

### BLMQ, 4 Foot, Side Dims

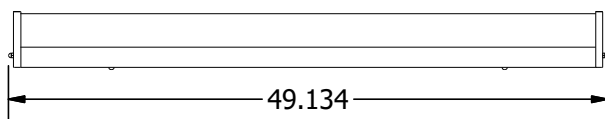

### End View

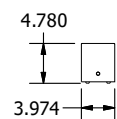

### Important Information

Please note that the total fixture wattage will depend on both the up light and down light selected.

For example: If your product name was BFMQ-4'-2.5L-2.0L-840-UNV-L53-R17, your fixture wattage is 49 watts, because the 2.5(up) and 2.0(down) light wattages together equal 49.0 watts. \*Actual wattages may vary.

### BLMQ, 4 Foot Wattage

Length	Lumens	Wattage
4'	2.00	21.00
4'	2.50	28.00
4'	3.00	33.00

### BLMQ, Light Loss Factor (LLF)

CCT	Output%
2700K	92.95
3000K	95.51
3500K	96.80
4000K	100.00
5000K	101.28
90CRI	84.72

- \* Drawings aren't to scale
- \* Standard tolerances apply
- \* Specifications may change without notice

BLMQ-4'-4L-4L-840-UNV-L53

**Cone of Light**

Mtg Height (ft)	Light Level (fc)	Beam Diameter (ft)
6.00	28.90	12.50
8.00	16.20	16.60
10.00	10.40	20.80
12.00	7.20	24.90
14.00	5.30	29.10
16.00	4.10	33.30

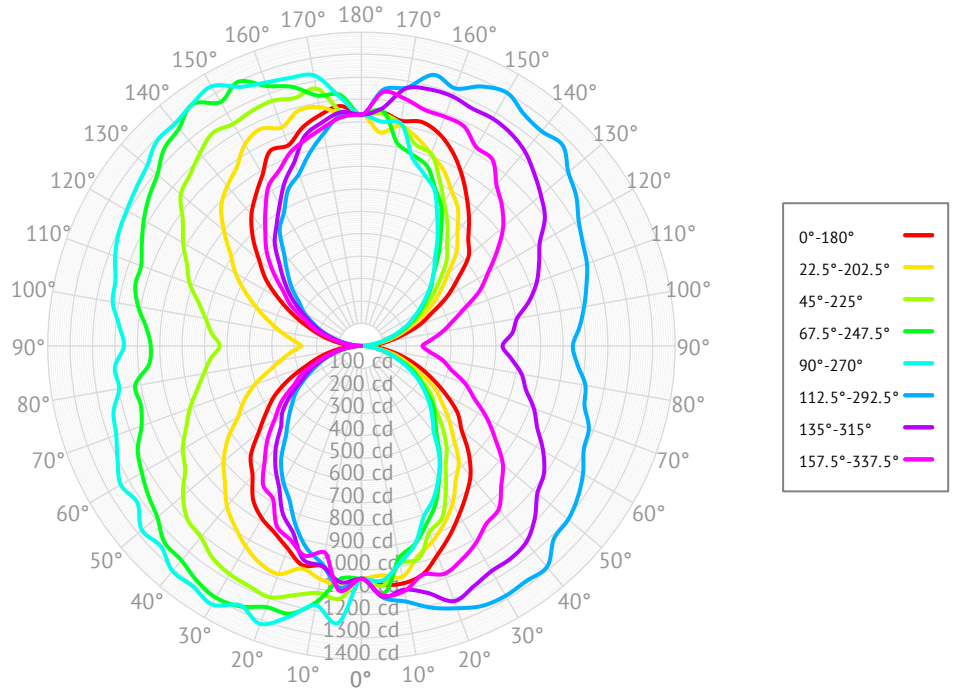

Based on BLMQ-4'-4L-4L-840-UNV-L53

## Emergency Battery Plan - 10W

Emergency Lighting	Solution System Components	System Operation
Option Code 'B17' - UL 924 listed components that are factory installed in the luminaire	UL 924 listed 10-watt battery integral to the luminaire	Loss of normal power is detected by the B17 emergency light solution and the power supply is switched automatically to the 10-watt integral battery pack which powers the emergency LED lighting driver.
	UL 924 listed LED emergency lighting driver integral to the luminaire	The battery pack and emergency LED driver are UL 924 certified to provide a minimum of 90-minutes of emergency lighting.
	Wiring options for both switched and unswitched emergency lighting	

## Emergency Lighting Wiring

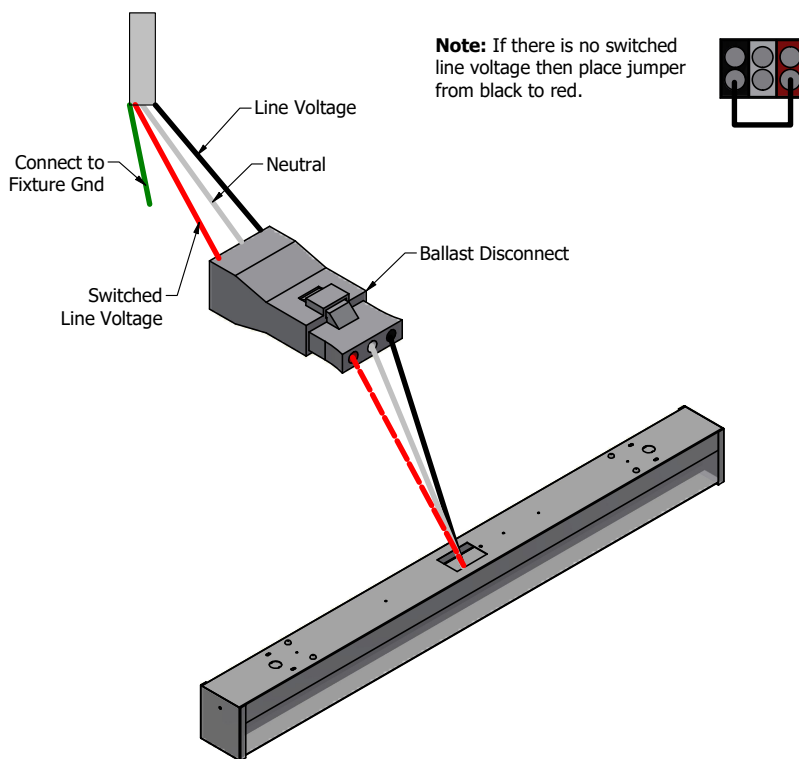

## Important Information

More information on emergency lighting options and configurations available on request.